

TECHNICAL DATA SHEET

RADIAL FAN nr. AFGG-40_08



G&G filtration CZ, s.r.o.

A Hrubínova 1903/9, 66451 Šlapanice, CZ
 IČ 05226953 IČ DPH CZ05226953
 E info@ggf.cz W www.ggf.cz

ITEM1

Document printed by Aeraulica - Dimensions and performances can be changed without prior notice

Type and characteristics of the requested machine				performance on				Outlet	
Flow rate	3700 [m3/h]			Capacity (Normal)				3448 [Nm3/h]	
Total pressure	4000 [Pa]			Static pressure					
Working fluid temperature	20 [°C]			Fluid specific weight				1.204 [Kg/m3]	
Installation altitude	0 asl [m]			Specific weight std (20 [°C], 0 asl [m])				1.204 [Kg/m3]	
Suggested model and effective characteristics				performance on				Outlet	
Model	GR 500R/2-I			Execution	E04			A (free inlet and outlet)	
Fluid specific weight	1.204			1.204 [Kg/m3]	Revolution fan speed				2930 [rpm]
Total pressure	3859			3859 [Pa]	Orientation				RD 0
Static pressure	3742			3742 [Pa]	Sound power LwA				101.2 [dB(A)]
Flow rate	3700			3700 [m3/h]	Sound pressure at mt.1.5 1/2 sf in open field				87.9 [dB(A)]
Capacity (Normal)	3448			3448 [Nm3/h]	Pipings	s>3mm = +3dB; 1mm<s<3mm = +4,5dB; s<1mm = +6dB			
Power dem. at shaft	4.971			4.971 [kW]	Fan efficiency	Outlet			79.79 %
Motor power demand	4.971			4.971 [kW]					
Characteristics of chosen motor				Motor efficiency IEC 60034-30				PD ² impeller	
Code	132SB2-50/std3			shape	B3			1.8 kgm ²	
Rated power	7.5 [kW]			n° poles	2			PD ² needed 1.78 kgm ²	
	rpm 2950			rpm	2950			PD ² motor 9 kgm ²	
ErP 2009/125/CE Regulament (UE) N. 327/2011				Notes					
Efficiency grade	64			N	75.3			Total efficiency 72.97 %	
Impeller type	backward blades			Type of test	B/total			Flow rate 4259.86 [m3/h] Pressure 3553 [Pa]	
NOTE				Performance on Outlet GR 500R/2-I - E04 - D=0.48[m] - ρ=1.204[kg/m ³] - T=20[°C] - 0[m]a.s.l.					
Rpm Limit <=60 °C: 3500 Rpm									
values of the noise of fan obtained in ambient not reverberant with inlet and outlet ducts fully insulated									

TECHNICAL DATA SHEET

RADIAL FAN nr. AFGG-40_08



G&G filtration CZ, s.r.o.

A Hrubínova 1903/9, 66451 Šlapanice, CZ

IČ 05226953 IČ DPH CZ05226953

E info@ggf.cz W www.ggf.cz

ITEM1

Document printed by Aeraulica - Dimensions and performances can be changed without prior notice

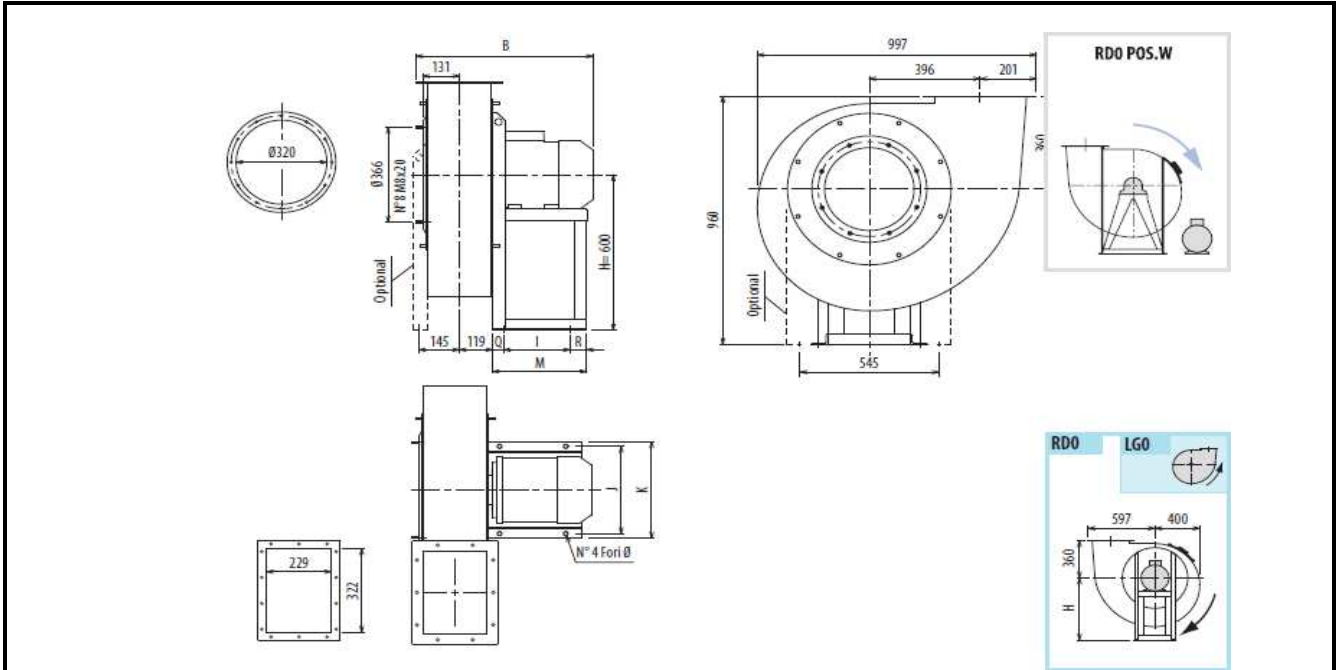

Indicative measures in the standard configuration. For detailed information contact your reference.

Indicative value of weight including standard motor.

B	I	H	H1	H2	J	K	M	Q	R	Φ	PD2	kg
640	237	600	360	600	337	372	346	44	64	12	1,8	145

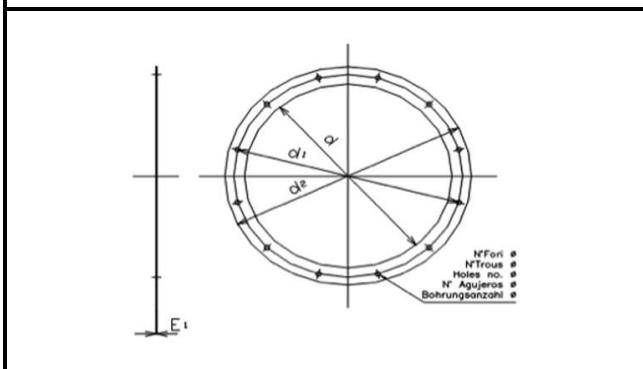

Cod	dxn°	d1	d2	Φ	E1
0320 A	320x8	366	400	12	4

--	--	--	--	--	--

--	--	--	--	--	--

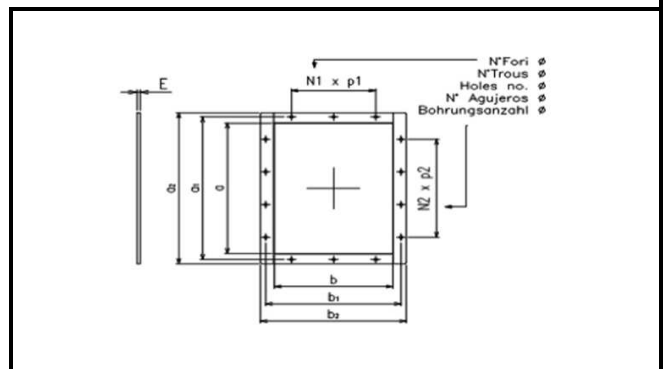

Cod	axb	a1	b1	a2	b2
0322x0229	322x229	366	273	402	309

N1xp	N2xp	n°	Φ	E
1x125	2x125	10	12	4

--	--	--	--	--