

TECHNICAL DATA SHEET

RADIAL FAN nr. AFGG-35_18



G&G filtration CZ, s.r.o.

A Hrubínova 1903/9, 66451 Šlapanice, CZ
 IČ 05226953 IČ DPH CZ05226953
 E info@ggf.cz W www.ggf.cz

ITEM1

Document printed by Aeraulica - Dimensions and performances can be changed without prior notice

Type and characteristics of the requested machine				performance on		Outlet		
Flow rate	22000 [m3/h]	Capacity (Normal)			20499 [Nm3/h]			
Total pressure	3550 [Pa]	Static pressure						
Working fluid temperature	20 [°C]	Fluid specific weight			1.204 [Kg/m3]			
Installation altitude	0 asl [m]	Specific weight std (20 [°C], 0 asl [m])			1.204 [Kg/m3]			
Suggested model and effective characteristics				performance on		Outlet		
Model	RM 1000R/4-I	Execution	E04	Installation Type	A (free inlet and outlet)			
Fluid specific weight	1.204	1.204 [Kg/m3]		Revolution fan speed		1475	[rpm]	
Total pressure	3839	3839 [Pa]		Orientation		RD 0		
Static pressure	3731	3731 [Pa]		Sound power LwA		107.59	[dB(A)]	
Flow rate	22000	22000 [m3/h]		Sound pressure at mt.1.5 1/2 sf in open field		94.29	[dB(A)]	
Capacity (Normal)	20499	20499 [Nm3/h]		Pipings	s>3mm = +3dB; 1mm<s<3mm = +4,5dB ; s<1mm = +6dB			
Power dem. at shaft	30.556	30.556 [kW]		Fan efficiency	Outlet	76.78	%	
Motor power demand	30.556	30.556 [kW]						
Characteristics of chosen motor				Motor efficiency IEC 60034-30			PD ² impeller	
Code	225M04-50/std3P	shape	B3	Efficiency	94.2	94.9	95.1	48.0 kgm ²
Rated power	45.0 [kW]	n° poles	4	rpm	1478			PD ² needed 47.81 kgm ²
				Load	100%	75%	50%	PD ² motor 198 kgm ²
ErP 2009/125/CE Regulament (UE) N. 327/2011				Notes				
Efficiency grade	64			N	72.5	Total efficiency	73.8	%
Impeller type	backward blades	Type of test	B/total	Flow rate	26284.32 [m3/h]	Pressure	3417 [Pa]	
NOTE				Performance on Outlet RM 1000R/4-I - E04 - D=0.96[m] - ρ=1.204[kg/m ³] - T=20[°C] - 0[m]a.s.l.				
Rpm Limit	<=60 °C: 1550 Rpm							
values of the noise of fan obtained in ambient not reverberant with inlet and outlet ducts fully insulated								

TECHNICAL DATA SHEET

RADIAL FAN nr. AFGG-35_18



G&G filtration CZ, s.r.o.

A Hrubínova 1903/9, 66451 Šlapanice, CZ

IČ 05226953 IČ DPH CZ05226953

E info@ggf.cz W www.ggf.cz

ITEM1

Document printed by Aeraulica - Dimensions and performances can be changed without prior notice

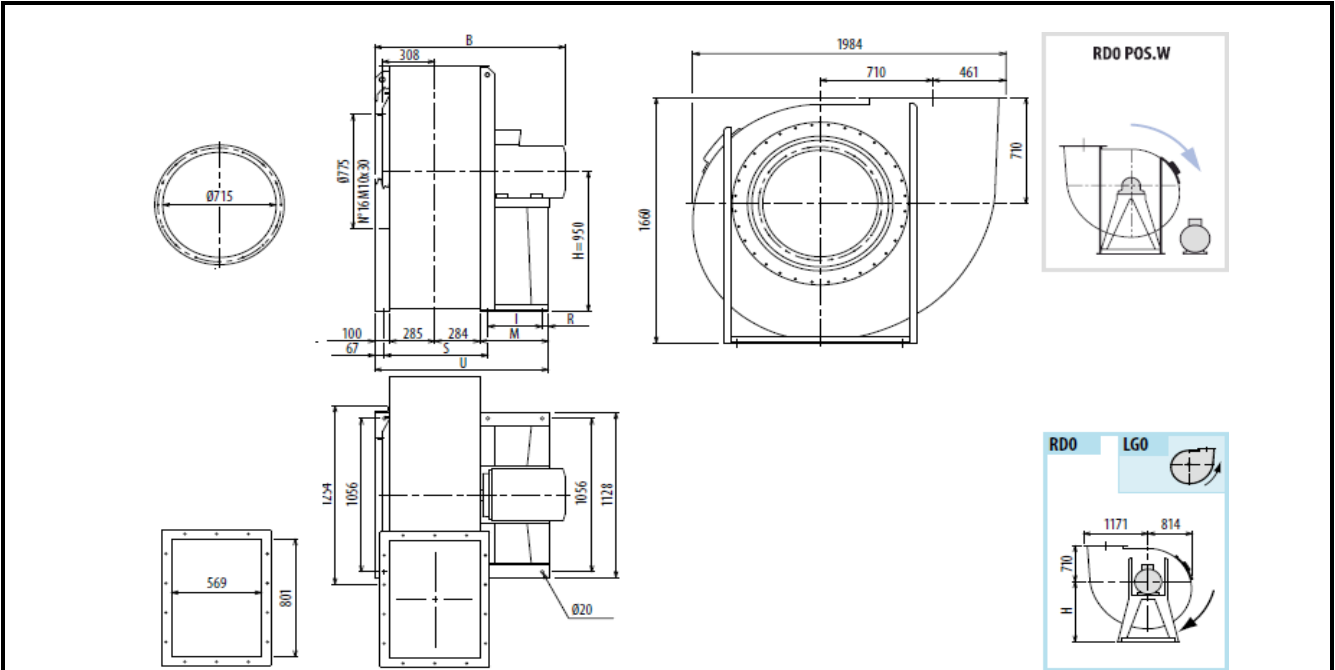

Indicative measures in the standard configuration. For detailed information contact your reference.

Indicative value of weight including standard motor.

B	I	H	H1	H2	R	S	M	U	PD2	kg
1378	440	950	710	1180	45	657	540	1209	48	963

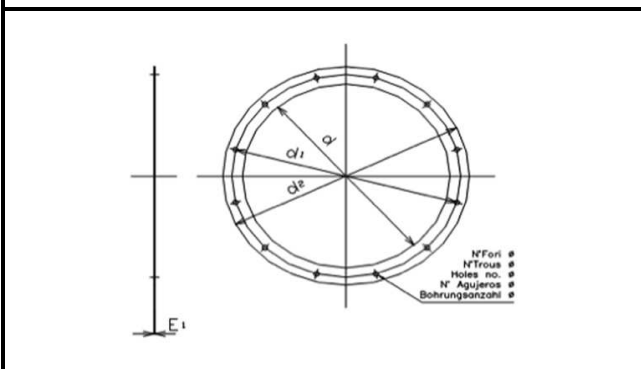

Cod	dxn°	d1	d2	Φ	E1
0715 A	715x16	775	815	14	5

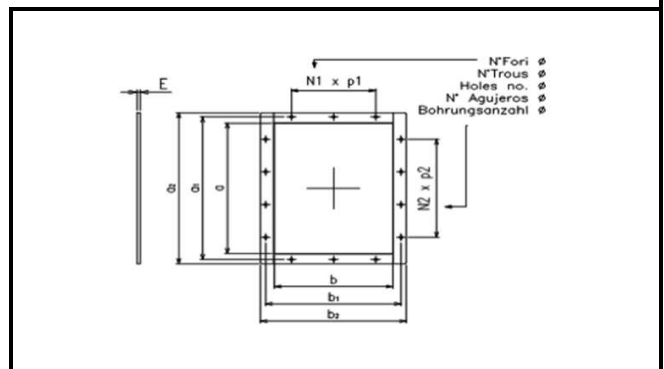

Cod	axb	a1	b1	a2	b2
0801x0569	801x569	871	639	921	689

N1xp	N2xp	n°	Φ	E
2x200	3x200	14	14	6